

EXHIBIT "A"
RELOCATED ORR DITCH EASEMENT

All that certain Relocated Orr Ditch easement situate within the Northwest One-Quarter (NW 1/4) of Section 32, Township 20 North, Range 20 East, M.D.M., City of Sparks, Washoe County, State of Nevada, being a portion of Parcel 3-A of Record of Survey Map No. 6341, File No. 5281658, recorded on March 2, 2022, in the Official Records of Washoe County, being more particularly described as follows:

COMMENCING at the Northwest corner of said Parcel 3-A;

THENCE along the Westerly boundary of said Parcel 3-A, South 00°00'00" East a distance of 615.59 feet;

THENCE departing said Westerly boundary, South 03°38'45" West a distance of 264.36 feet to the Westerly boundary of the Orr Ditch Easement per Parcel Map No. 5369, File No. 4850128, recorded on September 12, 2018, in said Official Records, also being the **POINT OF BEGINNING**;

THENCE along said Westerly boundary of said Orr Ditch Easement, South 24°38'28" East a distance of 8.65 feet to the beginning of a non-tangent curve to the left;

THENCE from a radial line which bears North 63°04'28" East, 107.03 feet along the arc of a 174.32 foot radius curve through a central angle of 35°10'43";

THENCE departing said Westerly boundary, South 75°13'54" West a distance of 133.19 feet;

THENCE North 14°46'06" West a distance of 30.00 feet;

THENCE South 75°13'54" West a distance of 375.98 feet;

THENCE South 14°46'06" East a distance of 91.56 feet;

THENCE South 75°13'54" West a distance of 30.00 feet;

THENCE North 14°46'06" West a distance of 91.56 feet;

THENCE South 75°13'54" West a distance of 639.96 feet;

THENCE South 14°46'06" East a distance of 10.00 feet;

THENCE South 75°13'54" West a distance of 12.59 feet to the Easterly boundary of said Orr Ditch Easement;

THENCE along said Easterly boundary, North 12°38'13" West a distance of 60.04 feet;

THENCE departing said Easterly boundary, North 75°13'54" East a distance of 10.05 feet;

THENCE South 14°46'06" East a distance of 10.00 feet;

THENCE North 75°13'54" East a distance of 1046.08 feet;

THENCE North 14°46'06" West a distance of 30.00 feet;

THENCE North 75°13'54" East a distance of 79.59 feet to the **POINT OF BEGINNING**.

Containing 55,176 square feet of land, more or less.

See Exhibit A-1 attached hereto and made a part hereof.

The Basis of Bearings for this legal description is identical to said Record of Survey Map No. 6341.

Prepared by:
Wood Rodgers, Inc.
1361 Corporate Blvd.
Reno, Nevada 89502

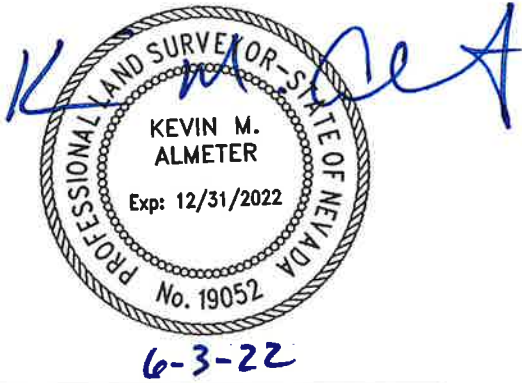

Kevin M. Almeter, P.L.S.
Nevada Certificate No. 19052

EXHIBIT A-1

PLAT TO ACCOMPANY

RELOCATED ORR DITCH EASEMENT
BEING A PORTION OF THE NW 1/4 OF SECTION 32
TOWNSHIP 20 NORTH, RANGE 20 EAST, M.D.M.
SPARKS WASHOE COUNTY NEVADA

WASHOE COUNTY
PARCEL 1-A R.O.S. 6341

HATCHED AREA
RELINQUISHED
HEREON



WASHOE COUNTY
APN 035-080-04

WASHOE COUNTY
APN 027-011-14
PARCEL A
T.M. 5487

SULLIVAN LANE

P.O.C.

S0°00'00"E
615.59'(TIE)

P.O.B.

S3°38'45"W
264.36'(TIE)

RELOCATED ORR
DITCH EASEMENT
(55,176± S.F.)

ORR DITCH EASEMENT
PER P.M. 5369
TO REMAIN

ORR DITCH EASEMENT
PER P.M. 5369
TO REMAIN

WASHOE COUNTY
APN 027-011-12
PARCEL 3-A
R.O.S. 6341

JOB NO. 8052018
SHEET 1 OF 1



WOOD RODGERS
BUILDING RELATIONSHIPS ONE PROJECT AT A TIME

1361 Corporate Boulevard Tel 775.823.4068
Reno, NV 89502 Fax 775.823.4068