

**LEGEND:**

- ◆ ◆ ◆ ◆ PLSS SECTION CORNER, AS NOTED
- FOUND 2" BRASS DISK IN CONCRETE, "RLS 164.3"
- FOUND MONUMENT AS NOTED
- DIMENSION POINT, NOTHING FOUND
- BOUNDARY
- PROPOSED ADJUSTED PARCEL LINE
- - - SECTION & SECTION BREAKDOWN LINE
- - - - - TIE LINE

**BASIS OF BEARINGS:**

NEVADA STATE PLANE COORDINATE SYSTEM, WEST ZONE, NORTH AMERICAN DATUM OF 1983/1994, HIGH ACCURACY REFERENCE NETWORK (NAD 83/94-HARN), AS DETERMINED USING REAL TIME KINEMATIC (RTK) GPS OBSERVATIONS WITH CORRECTIONS TRANSMITTED BY THE NEVADA GPS NETWORK (NGN GPS). THE BEARING BETWEEN GPS REFERENCE STATION "SSB2" - S52SM10000 AND "WWRP" - S11SM15000 IS TAKEN AS SOUTH 75°4'51" EAST. ALL DIMENSIONS SHOWN ARE GROUND DISTANCES. COMBINED GRID-TO-GROUND FACTOR = 1.000197939.

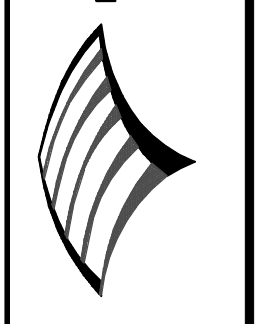
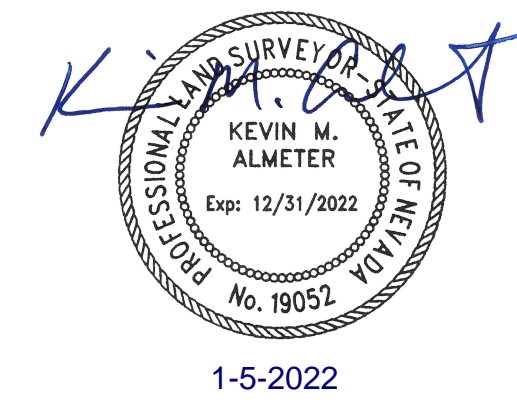

NO.	DATE

THE NORTH 1/2 OF THE SW 1/4 &  
 THE SE 1/4 OF THE SW 1/4 OF  
 SECTION 29, T. 20 N., R. 20 E., M.D.M.  
 SPARKS WASHOE COUNTY

**SECTION BREAKDOWN DIAGRAM**  
**FOR**  
**WASHOE COUNTY**

3:\data\8051 - Washoe County\8051\_Washoe\_County\_Geomatics\mappings\VC\_035-080-04\_BND.dwg 1/5/2022 4:31 PM Paul Roubius

**LEGAL DESCRIPTION  
THE PURCHASE PARCEL**

All that certain real property situate within the City of Sparks, County of Washoe, State of Nevada, being the Southeast One-Quarter (SE 1/4) of the Southwest One-Quarter (SW 1/4) of Section Twenty-Nine (29), Township Twenty (20) North, Range Twenty (20) East, Mount Diablo Base and Meridian.

A portion of Washoe County APN 035-080-04 containing 39.05 acres of land, more or less.

*Note to recorder: This document is not intended to be a conveyance or transfer of fee title.*

Prepared by:  
Wood Rodgers, Inc.  
1361 Corporate Blvd.  
Reno, NV 89502



---

Kevin M. Almeter, P.L.S.  
Nevada Certificate No. 19052